

# Adbry<sup>®</sup>

(tralokinumab-ldrm)  
Injection 150 mg • 300 mg



## Adbry<sup>®</sup> Single-Dose Autoinjector

A step-by-step guide to injecting at home

Not actual size.

Please see Indication and Important Safety Information on pages 14-15 of this brochure and accompanying full Prescribing Information, Patient Information, and Instructions for Use in the pocket.

## Important information to know before using the Adbry Autoinjector:

### This Instructions for Use Brochure contains information on how to inject with the autoinjector.

Read this Instructions for Use Brochure before you start using the Adbry® (tralokinumab-ldrm) Autoinjector and each time you get a refill as there may be new information. Having this information does not take the place of talking to your healthcare provider about your medical condition or your treatment.

**Keep this Instructions for Use Brochure and refer to it as needed.**

**Each autoinjector contains 300 mg of Adbry. The Adbry Autoinjector is for one-time use only.**

#### INDICATION AND IMPORTANT SAFETY INFORMATION

##### What is Adbry?

- Adbry is a prescription medicine used to treat people 12 years of age and older with moderate-to-severe atopic dermatitis (eczema) that is not well controlled with prescription therapies used on the skin (topical), or who cannot use topical therapies. Adbry can be used with or without topical corticosteroids.
- It is not known if Adbry is safe and effective in children under 12 years of age.

**Do not use Adbry if you are allergic to tralokinumab or to any of the ingredients in Adbry.**

- Adbry is given as an injection under the skin (subcutaneous injection)
- Your healthcare provider should show you how to prepare and inject Adbry using the autoinjector before you inject Adbry for the first time. Talk to your healthcare provider if you have any questions about how to inject Adbry the right way
- **Do not** inject yourself or someone else until you have been shown how to inject Adbry the right way
- The Adbry Autoinjector is for use in **adults only**
- Talk to your healthcare provider about your prescribed dose before injecting Adbry
- **For your initial dose, you will use 2 autoinjectors. After the initial dose, you will use 1 autoinjector for maintenance doses**

##### One-time Initial Loading Dose



To get your full prescribed initial loading dose of **600 mg**, you will need to give **2 injections** at different injection sites within the same body area

##### Maintenance Dose



To get your full prescribed dose of **300 mg**, you will need to give **1 injection**

- **Rotate the body area for each new injection**
- The Adbry Autoinjector has a needle guard that will be activated to cover the needle after the injection is finished
- **Do not** remove the cap until just before you give the injection
- **Do not** share or reuse your Adbry Autoinjector
- **Do not** inject through clothes

**Please see Indication and Important Safety Information on pages 14-15 of this brochure and accompanying full Prescribing Information, Patient Information, and Instructions for Use in the pocket.**

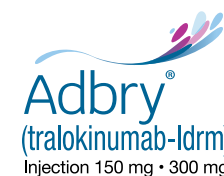
**Adbry**<sup>®</sup>  
(tralokinumab-ldrm)  
Injection 150 mg • 300 mg



## Adbry Autoinjector parts (see Figure A):

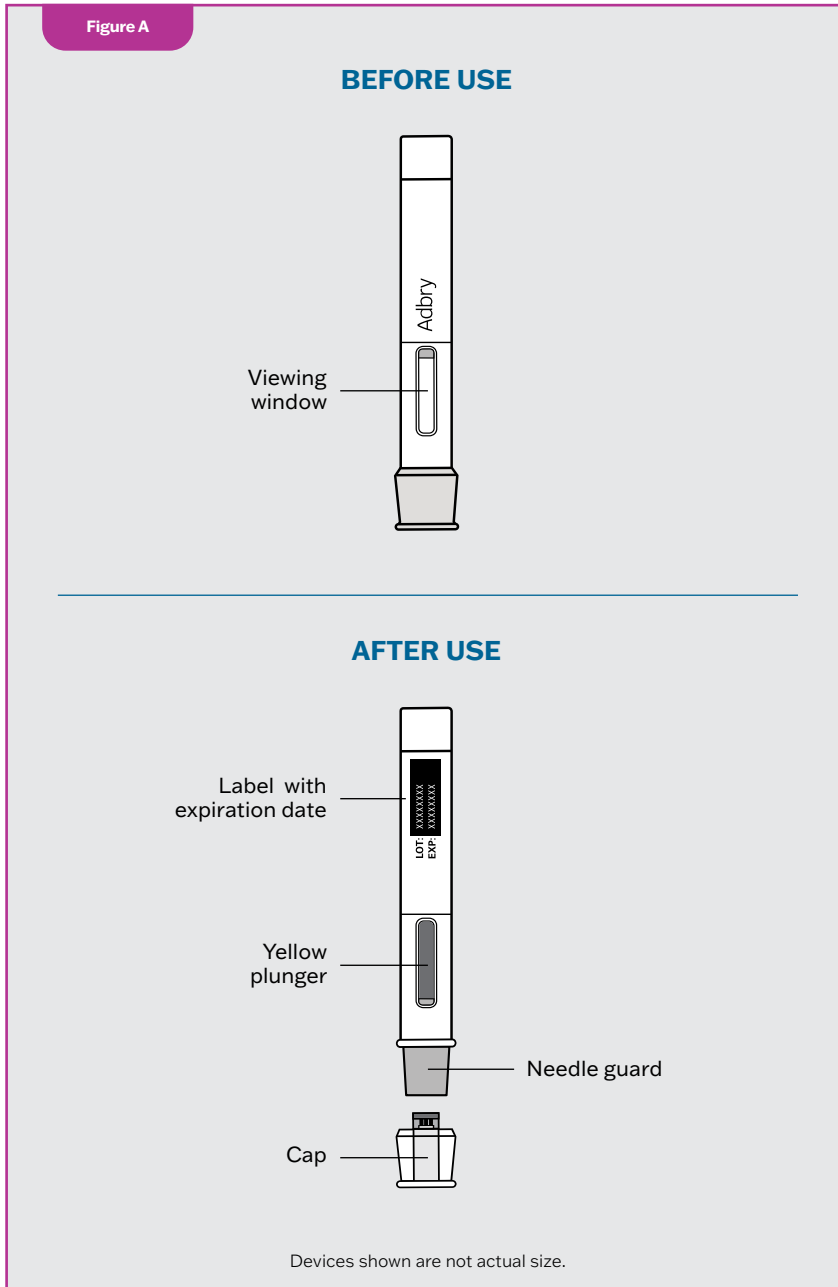

## Storing Adbry



- Store Adbry Autoinjectors in a refrigerator between 36°F to 46°F (2°C to 8°C)
- Store Adbry Autoinjectors in the original carton and protect from light until you are ready to use them
- Adbry can be stored in the original carton at room temperature up to 86°F (30°C) for up to 14 days. **If removed from the refrigerator**, write down the date of removal on the back of the carton and use the autoinjector within 14 days. Throw away (dispose of) the autoinjectors in a sharps disposal container if left out of the refrigerator for more than 14 days
- **Do not** freeze Adbry Autoinjectors. Do not use if they have been frozen
- **Do not** shake Adbry
- **Do not** heat Adbry
- **Do not** put Adbry into direct sunlight
- **Keep Adbry Autoinjectors and all medicines out of the reach of children. Contains small parts**



Not actual size.

Please see Indication and Important Safety Information on pages 14-15 of this brochure and accompanying full Prescribing Information, Patient Information, and Instructions for Use in the pocket.

**Adbry**<sup>®</sup>  
(tralokinumab-ldrm)  
Injection 150 mg • 300 mg

# Step 1: Setting up your Adbry injection

## 1a Gather the supplies needed for your injection. For each Adbry dose you will need (see Figure B):

- A clean, flat, well-lit work surface, like a table
- 1 Adbry Autoinjector
- An alcohol swab (not included in the carton)
- Clean cotton balls or gauze pads (not included in the carton)
- A puncture-resistant sharps disposal container (not included in the carton)  
**See Step 4 “Throwing away (disposing of) Adbry Autoinjectors”** at the end of this Instructions for Use

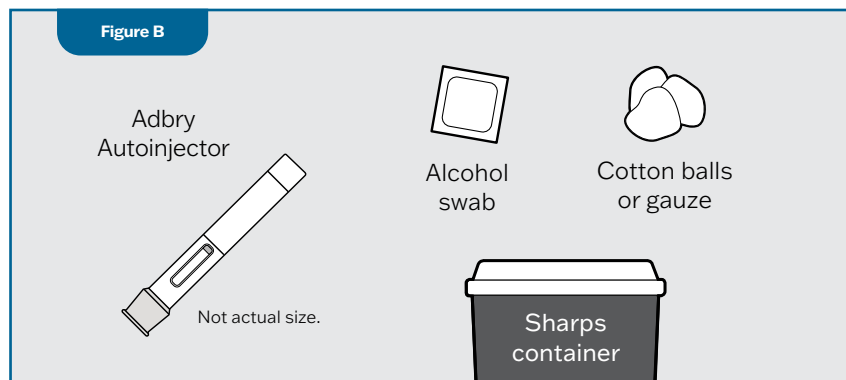

## 1b Take the Adbry Autoinjector carton out of the refrigerator

Check the expiration date (EXP) on the carton (see Figure C). **Do not** use if the expiration date on the carton has passed.

Check to make sure the seal on the Adbry carton is intact. **Do not** use the Adbry Autoinjectors if the seal on the carton is broken.

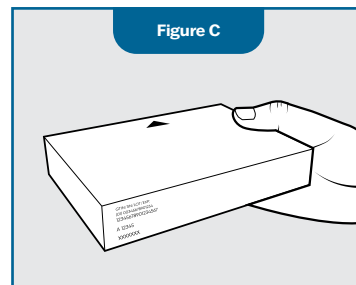

## 1c Remove the Adbry Autoinjector from the carton

Remove 1 autoinjector from the carton (see Figure D).

- **When using the first autoinjector, put the carton with the remaining autoinjector back in the refrigerator**
- **Do not** remove the cap on the autoinjector until you have reached Step 3 and are ready to inject

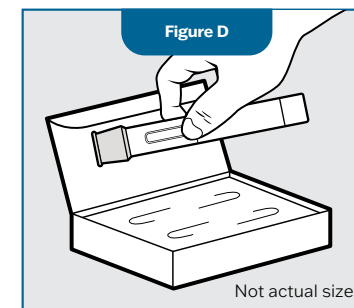

## 1d Let the Adbry Autoinjector warm up to room temperature

Place the autoinjector on the flat surface and wait at least 45 minutes before you inject Adbry to let the autoinjector warm up to room temperature 68°F to 86°F (20°C to 30°C) (see Figure E). This will help to reduce discomfort.

- **Do not** microwave the autoinjector, run hot water over it, or leave it in direct sunlight
- **Do not** shake the autoinjector
- **Do not** put the autoinjector back in the refrigerator after it has reached room temperature

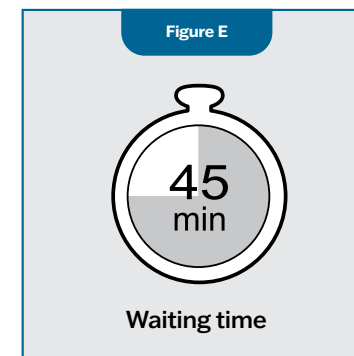

Please see Indication and Important Safety Information on pages 14-15 of this brochure and accompanying full Prescribing Information, Patient Information, and Instructions for Use in the pocket.

## Step 1: Setting up your Adbry injection (continued)

### 1e Inspect the Adbry Autoinjector (see Figure F)

- Make sure **Adbry** appears on the **label**
- **Check the expiration date (EXP)** printed on the autoinjector label
- **Check the medicine** through the viewing window. The medicine inside should be **clear to slightly pearly and colorless to pale yellow**
- You **may see small air bubbles in the liquid**. This is **normal**. You do not need to do anything about it
- **Do not** use the Adbry Autoinjector (throw away in a sharps disposal container) and get a new one if:

- The expiration date printed on the autoinjector label has passed
- The medicine is cloudy, discolored, or has particles in it
- It looks damaged or has been dropped

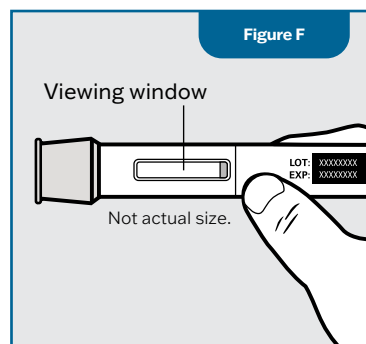

## Step 2: Choosing and preparing an injection area

### 2a Choose the area for your injections (see Figure G)

- **You may inject into:**
  - Your stomach area (abdomen)
  - Your thighs
  - Your upper arm. To inject into your upper arm, you will need a caregiver to give you the injections
- **Do not** inject within 2 inches (5 cm) of your belly button (navel)
- **Do not** inject where the skin is tender, damaged, bruised, or scarred

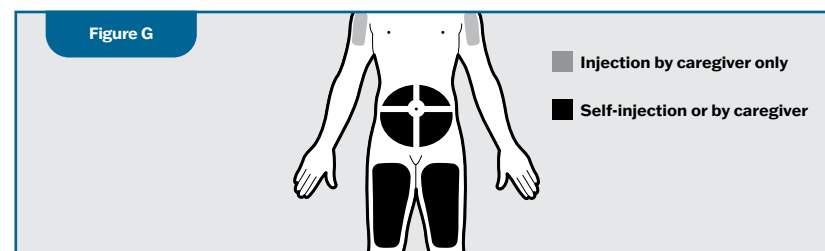

- **Rotate the body area with each following set of injections.**  
**Do not use the same body area 2 times in a row**

### 2b Wash your hands and prepare your skin (see Figure H)

- Wash your hands with soap and water
- Clean the injection area with an alcohol swab using a circular motion (see Figure H)
  - Let the area dry completely
  - **Do not** blow or touch the cleaned area before injecting

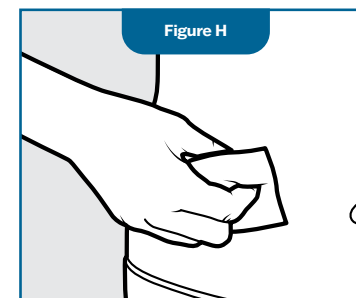

Please see Indication and Important Safety Information on pages 14-15 of this brochure and accompanying full Prescribing Information, Patient Information, and Instructions for Use in the pocket.

  
**Adbry**<sup>®</sup>  
(tralokinumab-ldrm)  
Injection 150 mg • 300 mg

## Step 3: Injecting Adbry

### 3a Pull off the Adbry cap

Hold the autoinjector with one hand, pull the cap straight off with your other hand (see Figure I), and throw it away in the sharps container. The needle guard is now exposed. It is there to prevent you from touching the needle.

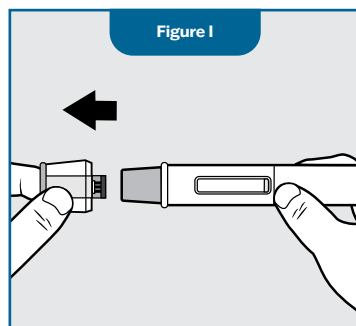

- **Do not** try to recap the autoinjector. This could cause the injection to happen too soon or damage the needle
- **Do not** try to touch or push on the needle guard with your finger. This could cause needle stick injury

### 3b Place the Adbry Autoinjector at the injection area as shown in Figure J so that you can see the viewing window

You can gently pinch the skin where you cleaned the injection area or give injection without pinching the skin. Follow your healthcare provider's instructions on how to inject.

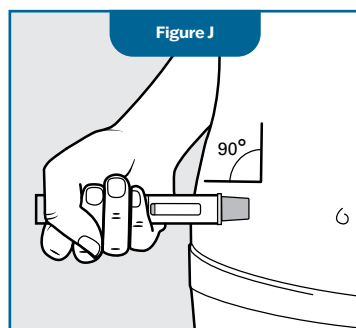

- Place the needle guard of the autoinjector flat against your skin (90-degree angle) at the injection area you have cleaned. Make sure you can see the viewing window (see Figure J)
- Do not change the position of the autoinjector after the injection has started

**If the autoinjector is removed too soon, you may see a stream of medicine coming from the autoinjector. If this happens you may not have received your full dose. Call your healthcare provider.**

Devices shown are not actual size.

### 3c Press down on the Adbry Autoinjector and hold pressure

Press the autoinjector down firmly and hold it in place (see Figure K). You will hear a “click” to let you know that the injection has started and the yellow plunger will start to move.

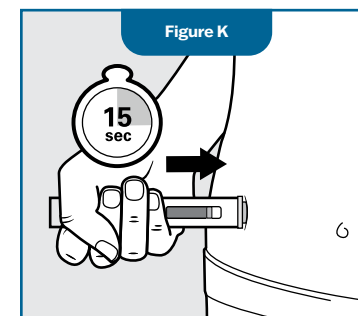

The yellow plunger will move to the bottom of the viewing window as the medicine is being injected. **It may take up to 15 seconds to inject the full dose.**

You will hear a second “click” when the yellow plunger fills the viewing window. **Keep pressing.**

### 3d Continue to press down for another 5 seconds

After the second “click,” continue to press the autoinjector firmly against your skin for 5 seconds to make sure you get your full dose (see Figure L).

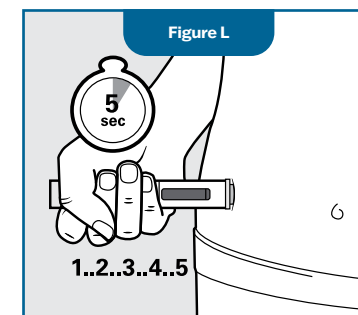

Devices shown are not actual size.

Please see Indication and Important Safety Information on pages 14-15 of this brochure and accompanying full Prescribing Information, Patient Information, and Instructions for Use in the pocket.

**Adbry**<sup>®</sup>  
(tralokinumab-ldrm)  
Injection 150 mg • 300 mg

### Step 3: Injecting Adbry (continued)

#### 3e Remove the Adbry Autoinjector

Pull the autoinjector straight away from the injection area (see **Figure M**). The needle guard will slide down and lock into place over the needle.

Place a dry cotton ball or gauze pad over the injection area for a few seconds. **Do not** rub the injection area.

There may be a small amount of blood or liquid where you injected. This is normal. If needed, cover the injection area with a small bandage.

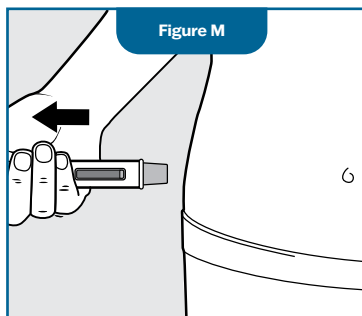

#### 3f Check the viewing window

Check the viewing window to make sure all the liquid has been injected (see **Figure N**).

If the yellow plunger does not fill the viewing window you may not have received the full dose. If this happens or if you have any other concerns, call your healthcare provider and call LEO Pharma at 877-494-4536 to report a product quality complaint.

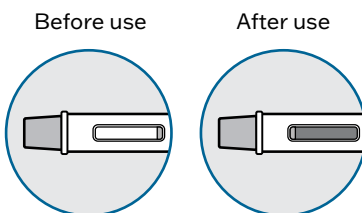
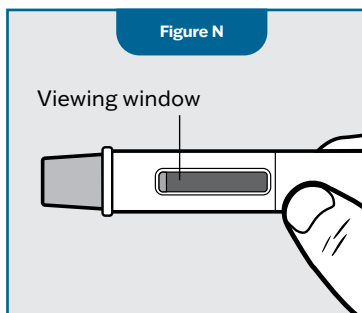

Devices shown are not actual size.

## Step 4: Throwing away (disposing of) Adbry Autoinjectors

4 Put the used Adbry Autoinjectors in an FDA-cleared sharps disposal container right away after use (see **Figure O**).

- **Do not** throw away the Adbry Autoinjectors in your household trash.
- If you do not have an FDA-cleared sharps disposal container, you may use a household container that is:

- made of a heavy-duty plastic
- can be closed with a tight-fitting, puncture-resistant lid, without sharps being able to come out
- upright and stable during use
- leak-resistant
- properly labeled to warn of hazardous waste inside the container

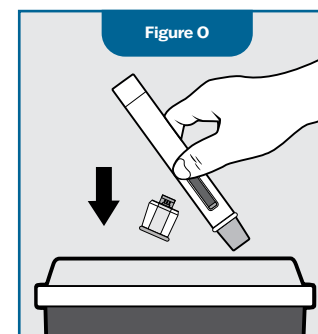

Device shown is not actual size.

- When your sharps disposal container is almost full, you will need to follow your community guidelines for the right way to dispose of your sharps disposal container. There may be state or local laws about how you should throw away used Adbry Autoinjectors. For more information about safe sharps disposal and specific information about sharps disposal in the state that you live in, go to the FDA's website at: <http://www.fda.gov/safesharpsdisposal>
- **Do not** dispose of your used sharps disposal container in your household trash unless your community guidelines permit this. **Do not** recycle your used sharps disposal container

For more information go to [www.Adbry.com](http://www.Adbry.com) or call 1-844-692-3279.  
If you still have questions, call your healthcare provider.

Please see Indication and Important Safety Information on pages 14-15 of this brochure and accompanying full Prescribing Information, Patient Information, and Instructions for Use in the pocket.

  
Adbry®  
(tralokinumab-ldrm)  
Injection 150 mg • 300 mg

# Indication and Important Safety Information

## What is ADBRY?

- ADBRY® (tralokinumab-ldrm) injection is a prescription medicine used to treat people 12 years of age and older with moderate-to-severe atopic dermatitis (eczema) that is not well controlled with prescription therapies used on the skin (topical), or who cannot use topical therapies. ADBRY can be used with or without topical corticosteroids.
- It is not known if ADBRY is safe and effective in children under 12 years of age.

**Do not use Adbry if you are allergic to tralokinumab or to any of its ingredients.**

## What should I discuss with my healthcare provider before starting ADBRY?

**Tell your healthcare provider about all your medical conditions, including if you:**

- have eye problems.
- have a parasitic (helminth) infection.
- are scheduled to receive any vaccinations. You should not receive a “live vaccine” if you are treated with ADBRY.
- are pregnant or plan to become pregnant. It is not known whether ADBRY will harm your unborn baby. There is a pregnancy exposure registry for women who use ADBRY during pregnancy. The purpose of this registry is to collect information about the health of you and your baby. You or your healthcare provider can get information and enroll you in this registry by calling 1-877-311-8972 or visiting <https://mothertobaby.org/ongoing-study/adbry-tralokinumab/>.
- are breastfeeding or plan to breastfeed. It is not known whether ADBRY passes into your breast milk and if it can harm your baby.

Tell your healthcare provider about all the medicines you take, including prescription and over-the-counter medicines, vitamins, and herbal supplements.

## How should I use ADBRY?

- **See the detailed “Instructions for Use” that comes with ADBRY for information on how to prepare and inject ADBRY and how to properly store and throw away (dispose of) used ADBRY prefilled syringes and autoinjectors.**
- Use ADBRY exactly as prescribed by your healthcare provider.
- Your healthcare provider will tell you how much ADBRY to inject and when to inject it.
- ADBRY comes as a single-dose prefilled syringe with needle guard or as an autoinjector.

- ADBRY is given as an injection under the skin (subcutaneous injection).
- If your healthcare provider decides that you or a caregiver can give the injections of ADBRY, you or your caregiver should receive training on the right way to prepare and inject ADBRY. **Do not** try to inject ADBRY until you have been shown the right way by your healthcare provider. In children 12 years of age and older, it is recommended that ADBRY be given by or under supervision of an adult.
- If you miss a dose, inject the missed dose as soon as possible, then continue with your next dose at your regular scheduled time.
- If you inject too much ADBRY than prescribed, call your healthcare provider or call Poison Help line at 1-800-222-1222 or go to the nearest hospital emergency room right away.
- Your healthcare provider may prescribe other medicines to use with ADBRY. Use the other prescribed medicines exactly as your healthcare provider tells you to.

## What are the possible side effects of ADBRY?

**ADBRY can cause serious side effects including:**

- **Allergic reactions (hypersensitivity), including a severe reaction known as anaphylaxis.** Stop using ADBRY and tell your healthcare provider or get emergency help right away if you get any of the following symptoms:
  - breathing problems
  - itching
  - skin rash
  - swelling of the face, mouth, and tongue
  - fainting, dizziness, feeling lightheaded (low blood pressure)
  - hives
- **Eye problems.** Tell your healthcare provider if you have any new or worsening eye problems, including eye pain or changes in vision.

**The most common side effects of ADBRY include:**

- Upper respiratory tract infections
- Eye and eyelid inflammation, including redness, swelling, and itching
- Injection site reactions
- High count of a certain white blood cell (eosinophilia)

These are not all the possible side effects of ADBRY. Call your doctor for medical advice about side effects. You may report side effects to FDA at 1-800-FDA-1088.

**Please see the accompanying full Prescribing Information, Patient Information, and Instructions for Use in the pocket.**





**Adbry**<sup>®</sup>  
(tralokinumab-ldrm)  
Injection 150 mg • 300 mg



**Adbry**<sup>®</sup> Prefilled  
Syringe

A step-by-step guide  
to injecting at home

Not actual size.

Please see Indication and Important Safety Information on pages 14-15 of this brochure and accompanying full Prescribing Information, Patient Information, and Instructions for Use in the pocket.

## Important information to know before using the Adbry prefilled syringes:

### This Instructions for Use Brochure contains information on how to inject with the prefilled syringes.

Read this Instructions for Use Brochure before you start using Adbry® (tralokinumab-ldrm) prefilled syringes and each time you get a refill. There may be new information, so make sure you check the leaflet that comes in your Adbry carton with the syringes before you inject every time. Having this information does not take the place of talking to your healthcare professional about your medical condition or your treatment.

**Keep this Instructions for Use Brochure and refer to it as needed.**

**Each single-dose prefilled syringe contains 150 mg of Adbry. The Adbry prefilled syringes are for single use only.**

#### INDICATION AND IMPORTANT SAFETY INFORMATION

##### What is Adbry?

- Adbry is a prescription medicine used to treat people 12 years of age and older with moderate-to-severe atopic dermatitis (eczema) that is not well controlled with prescription therapies used on the skin (topical), or who cannot use topical therapies. Adbry can be used with or without topical corticosteroids.
- It is not known if Adbry is safe and effective in children under 12 years of age.

**Do not use Adbry if you are allergic to tralokinumab or to any of the ingredients in Adbry.**

- Your **healthcare professional should show you how** to prepare and inject Adbry using the prefilled syringes **before you inject Adbry for the first time**
- **Do not** inject yourself or someone else until you have been shown how to inject Adbry the right way
- Talk to your healthcare professional if you have any **questions about how to inject** Adbry the right way
- Your healthcare professional will determine if you will receive your **initial loading dose (4 injections) in their office**
- **To receive your full prescribed dose, you will need to give more than 1 Adbry injection**

##### One-time Initial Loading Dose



To get your full prescribed initial loading dose of **600 mg**, you will need to give **4 injections** at different injection sites within the same body area

##### Maintenance Dose



To get your full prescribed dose of **300 mg**, you will need to give **2 injections** at different injection sites within the same body area

- **It is recommended to rotate the body area with each new set of injections**
- The Adbry prefilled syringes have a needle guard that will be activated to cover the needle after the injection is finished
- For subcutaneous injection only (inject directly into fatty layer under the skin)
- **Do not** remove the needle cover until just before you give the injection
- **Do not** share or reuse your Adbry prefilled syringes
- **Do not** inject through clothes

**Please see Indication and Important Safety Information on pages 14-15 of this brochure and accompanying full Prescribing Information, Patient Information, and Instructions for Use in the pocket.**

**Adbry**<sup>®</sup>  
(tralokinumab-ldrm)  
Injection 150 mg • 300 mg



## Prefilled syringe parts (see Figure A):

Figure A

To receive your full initial loading dose, you must give 4 injections and to receive your full maintenance dose you must give 2 injections using separate prefilled syringes.

### BEFORE USE

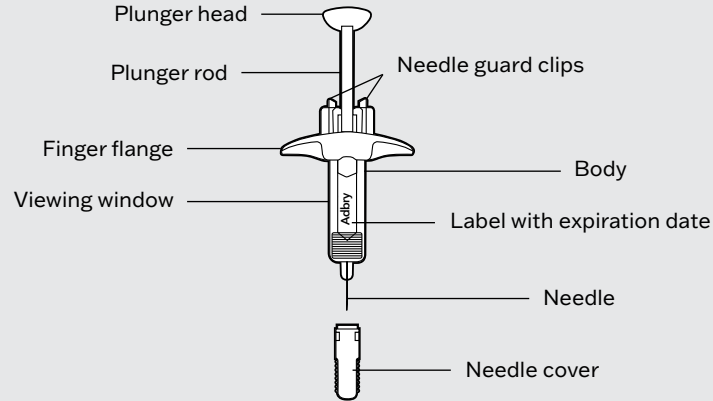

### AFTER USE

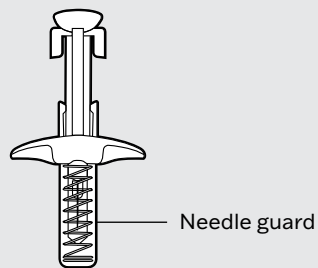

Devices shown are not actual size.

## Storing



- Store Adbry® prefilled syringes in a **refrigerator between 2°C to 8°C (36°F to 46°F)**
- Store Adbry prefilled syringes in the original carton and protect from light until you are ready to use them
- Adbry can be stored in the original carton at room temperature up to 30°C (86°F) for up to 14 days. Throw away (dispose of) syringes if left out of the refrigerator for more than 14 days
- **Do not** freeze Adbry prefilled syringes. **Do not** use if they have been frozen
- **Do not** shake the Adbry prefilled syringe
- **Do not** heat the Adbry prefilled syringe
- **Do not** put the Adbry prefilled syringe into direct sunlight
- **Keep Adbry prefilled syringes and all medicines out of the reach of children**



Not actual size.

Please see Indication and Important Safety Information on pages 14-15 of this brochure and accompanying full Prescribing Information, Patient Information, and Instructions for Use in the pocket.

# Step 1: Setting up the maintenance injection

## 1a Gather the supplies needed for your injection. For each Adbry® dose you will need (see Figure B):

- A clean, flat, well-lit work surface, like a table
- 1 Adbry **carton** that contains 2 Adbry prefilled **syringes**
- An alcohol swab (not included in the carton)
- Clean gauze pads or cotton balls (not included in the carton)
- Bandages (not included in the carton)
- A puncture-resistant sharps disposal container (not included in the carton).  
**See Step 5 "Disposing"** at the end of this Instructions for Use Brochure

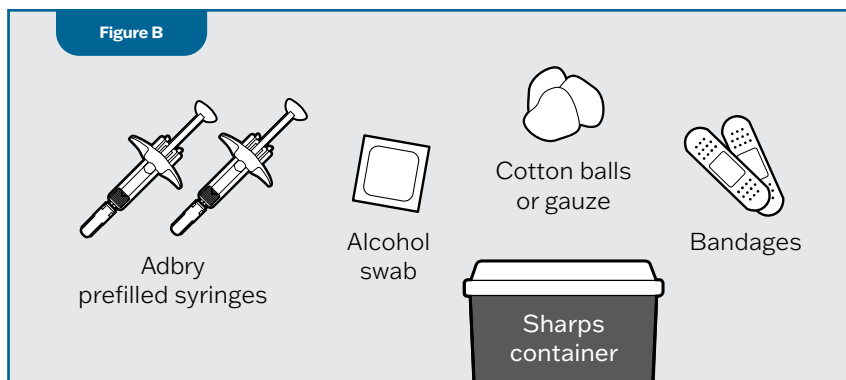

Devices shown are not actual size.

## 1b Take the Adbry prefilled syringe carton out of the refrigerator

- **Check the expiration date (EXP) on the carton (see Figure C). Do not** use if the expiration date on the carton has passed
- Check to make sure the seal on the Adbry carton is intact. **Do not** use the Adbry prefilled syringes if the seal on the carton is broken

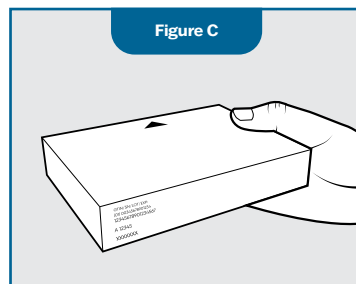

## 1c Let the Adbry prefilled syringes warm up to room temperature (see Figure D)

Set the Adbry **carton on the flat surface and wait 30 minutes** before you inject Adbry to let the prefilled syringes **warm up to room temperature**, 20°C to 30°C (68°F to 86°F). This will **help to reduce discomfort and make it easier to inject Adbry**.

- **Do not** microwave the prefilled syringes, run hot water over them, or leave them in direct sunlight
- **Do not** shake the syringes
- **Do not** remove the needle cover on the prefilled syringes until you have reached Step 3 and are ready to inject
- **Do not** put the syringes back in the refrigerator once they have reached room temperature

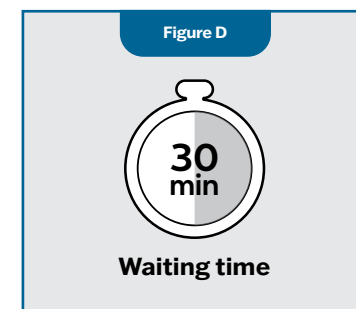

## 1d Remove the Adbry® prefilled syringes from the carton

Remove the 2 Adbry **prefilled syringes** one by one from the carton by **grasping the body (not the plunger rod)** of the Adbry prefilled syringes (see Figure E).

- **Do not** touch the needle guard clips to keep from activating the safety device (needle guard) too soon
- **Do not** remove the needle cover on the prefilled syringes until you have reached Step 3 and are ready to inject

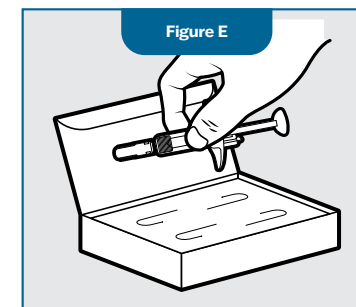

Device shown is not actual size.

Please see **Indication and Important Safety Information** on pages 14-15 of this brochure and accompanying **full Prescribing Information, Patient Information, and Instructions for Use in the pocket.**

Adbry®  
(tralokinumab-ldrm)  
Injection 150 mg • 300 mg

## Step 1: Setting up the injection (continued)

### 1e Inspect the 2 Adbry prefilled syringes (see Figure F)

- Make sure **Adbry** appears on the **labels**
- **Check the expiration date** printed on the syringes
- **Check the medicine** through the viewing windows. The medicine inside should be **clear to slightly pearly and colorless to pale yellow**
- **Do not** use the Adbry prefilled syringes, and throw away and get new ones if:
  - The expiration date printed on the syringes has passed
  - The medicine is cloudy, discolored, or has particles in it
  - They look damaged or have been dropped
- You **may see small air bubbles in the liquid**. This is **normal**. You do not need to do anything about it

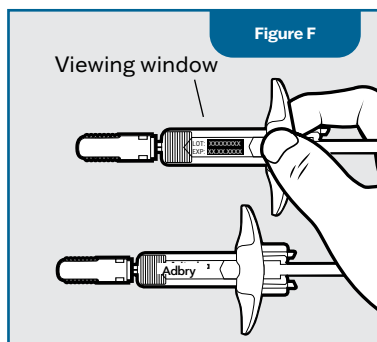

Devices shown are not actual size.

## Step 2: Choosing and preparing an injection area

### 2a Choose the area for your injections (see Figure G)

- **You may inject into:**
  - Your stomach area (abdomen)
  - Your thighs
  - Your upper arm. To inject into your upper arm, you will need a caregiver to give you the injections
- **Do not** inject within 2 inches (5 cm) of your belly button (navel)
- **Do not** inject where the skin is tender, damaged, bruised, or scarred

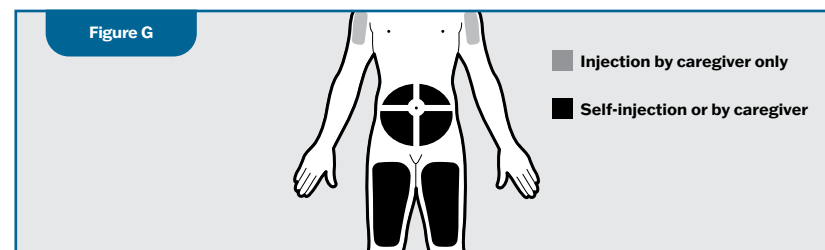

- **Rotate the body area with each following set of injections. Do not use the same body area 2 times in a row**

### 2b Wash your hands and prepare your skin (see Figure H)

- Wash your hands with soap and water
- Clean the injection area for the 2 injections with an alcohol swab using a circular motion (see **Figure H**)
  - Let the area dry completely
  - **Do not** blow or touch the cleaned area before injecting

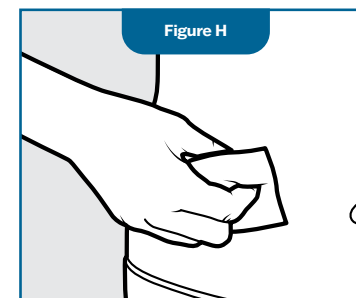

Please see **Indication and Important Safety Information** on pages 14-15 of this brochure and accompanying **full Prescribing Information, Patient Information, and Instructions for Use in the pocket.**

## Step 3: Injecting

### 3a Pull off the Adbry® needle cover

Hold the Adbry prefilled syringe body with one hand, pull the needle cover straight off with your other hand (see Figure I), and throw it away in the sharps container.

- Do not try to recap the Adbry prefilled syringes
- Do not hold the plunger rod or plunger head while removing the needle cover
- You may see a drop of liquid at the end of the needle. This is normal
- Do not touch the needle, or let it touch any surface. If either of these occur, throw away the syringe and get a new one

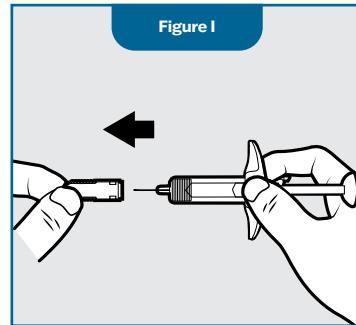

### 3b Insert the needle

With one hand, gently pinch and hold a fold of skin where you cleaned the injection area. With the other hand, insert the needle completely at about a 45-degree angle into your skin (see Figure J).

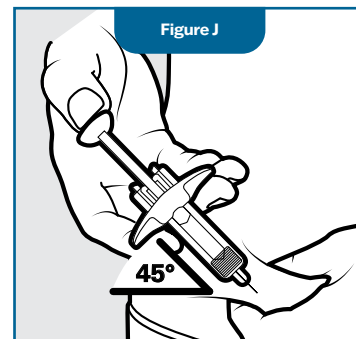

Devices shown are not actual size.

### 3c Inject the medicine

Use your thumb to firmly push down the plunger head all the way down (see Figure K). All of the medicine is injected when you cannot push the plunger head any further.

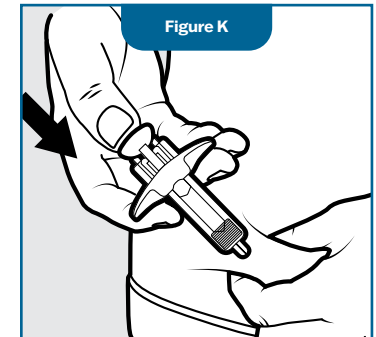

### 3d Release and remove

Lift your thumb off the plunger head. The needle will automatically move back inside the syringe body and lock into place (see Figure L).

- Place a dry cotton ball or gauze pad over the injection site for a few seconds. Do not rub the injection site. If needed, cover the injection site with a small bandage
- There may be a small amount of blood or liquid where you injected. This is normal

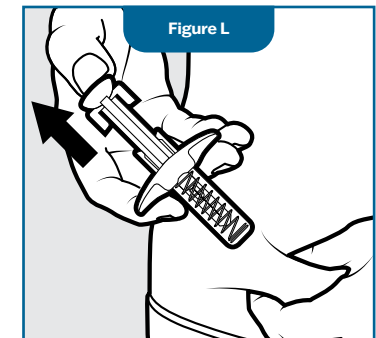

Throw away the used Adbry® prefilled syringe in the sharps disposal container. See Step 5 “Disposing.”

Devices shown are not actual size.

Please see Indication and Important Safety Information on pages 14-15 of this brochure and accompanying full Prescribing Information, Patient Information, and Instructions for Use in the pocket.

Adbry®  
(tralokinumab-ldrm)  
Injection 150 mg • 300 mg

## Step 4: Injecting the next syringe

**4** To get your full prescribed dose, you will need to give more than 1 injection.

- **Initial Loading Dose:** To get your full prescribed initial dose of **600 mg**, you will need to give **4 injections**
- **Maintenance Dose:** To get your full prescribed dose of **300 mg**, you will need to give **2 injections every other week**. Use Adbry as prescribed by your healthcare professional

Get a new Adbry prefilled syringe and repeat Steps 3 and 5 (see Figure M) for each injection you need to give for your full prescribed dose.

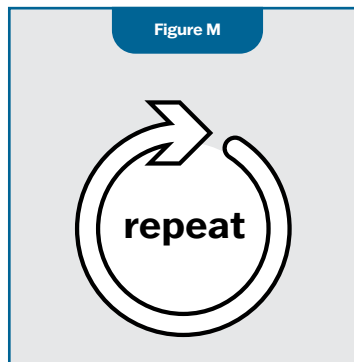

### NOTE

Make sure each injection is at least 1 inch (3 cm) from the prior injection site and within the same body area.

## Step 5: Disposing

**5** Put the used Adbry® prefilled syringes in an FDA-cleared sharps disposal container right away after use (see Figure N). Do not throw away the Adbry prefilled syringes in your household trash

- If you do not have an FDA-cleared sharps disposal container, you may use a household container that is:

- Made of heavy-duty plastic
- Able to be closed with a tight-fitting puncture-resistant lid, without sharps being able to come out
- Upright and stable during use
- Leak-resistant
- Properly labeled to warn of hazardous waste inside the container

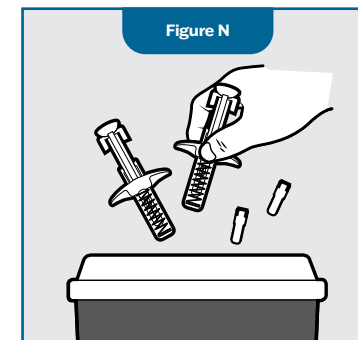

Devices shown are not actual size.

- When your sharps disposal container is almost full, you will need to follow your community guidelines for the right way to dispose of your sharps disposal container. There may be state or local laws about how you should throw away used needles and syringes. For more information about safe sharps disposal, and for specific information about sharps disposal in the state that you live in, go to the FDA's website at: <http://www.fda.gov/safesharpsdisposal>
- **Do not** recycle your used sharps disposal container



To request a **free sharps container**, call the Adbry® Advocate™ Program at 844-MY-ADBRY (844-692-3279)

Please see Indication and Important Safety Information on pages 14-15 of this brochure and accompanying full Prescribing Information, Patient Information, and Instructions for Use in the pocket.

**Adbry®**  
(tralokinumab-ldrm)  
Injection 150 mg • 300 mg

# Indication and Important Safety Information

## What is ADBRY?

- ADBRY® (tralokinumab-ldrm) injection is a prescription medicine used to treat people 12 years of age and older with moderate-to-severe atopic dermatitis (eczema) that is not well controlled with prescription therapies used on the skin (topical), or who cannot use topical therapies. ADBRY can be used with or without topical corticosteroids.
- It is not known if ADBRY is safe and effective in children under 12 years of age.

**Do not use Adbry if you are allergic to tralokinumab or to any of its ingredients.**

## What should I discuss with my healthcare provider before starting ADBRY?

**Tell your healthcare provider about all your medical conditions, including if you:**

- have eye problems.
- have a parasitic (helminth) infection.
- are scheduled to receive any vaccinations. You should not receive a “live vaccine” if you are treated with ADBRY.
- are pregnant or plan to become pregnant. It is not known whether ADBRY will harm your unborn baby. There is a pregnancy exposure registry for women who use ADBRY during pregnancy. The purpose of this registry is to collect information about the health of you and your baby. You or your healthcare provider can get information and enroll you in this registry by calling 1-877-311-8972 or visiting <https://mothertobaby.org/ongoing-study/adbry-tralokinumab/>.
- are breastfeeding or plan to breastfeed. It is not known whether ADBRY passes into your breast milk and if it can harm your baby.

Tell your healthcare provider about all the medicines you take, including prescription and over-the-counter medicines, vitamins, and herbal supplements.

## How should I use ADBRY?

- **See the detailed “Instructions for Use” that comes with ADBRY for information on how to prepare and inject ADBRY and how to properly store and throw away (dispose of) used ADBRY prefilled syringes and autoinjectors.**
- Use ADBRY exactly as prescribed by your healthcare provider.
- Your healthcare provider will tell you how much ADBRY to inject and when to inject it.
- ADBRY comes as a single-dose prefilled syringe with needle guard or as an autoinjector.

- ADBRY is given as an injection under the skin (subcutaneous injection).
- If your healthcare provider decides that you or a caregiver can give the injections of ADBRY, you or your caregiver should receive training on the right way to prepare and inject ADBRY. **Do not** try to inject ADBRY until you have been shown the right way by your healthcare provider. In children 12 years of age and older, it is recommended that ADBRY be given by or under supervision of an adult.
- If you miss a dose, inject the missed dose as soon as possible, then continue with your next dose at your regular scheduled time.
- If you inject too much ADBRY than prescribed, call your healthcare provider or call Poison Help line at 1-800-222-1222 or go to the nearest hospital emergency room right away.
- Your healthcare provider may prescribe other medicines to use with ADBRY. Use the other prescribed medicines exactly as your healthcare provider tells you to.

## What are the possible side effects of ADBRY?

**ADBRY can cause serious side effects including:**

- **Allergic reactions (hypersensitivity), including a severe reaction known as anaphylaxis.** Stop using ADBRY and tell your healthcare provider or get emergency help right away if you get any of the following symptoms:
  - breathing problems
  - itching
  - skin rash
  - swelling of the face, mouth, and tongue
  - fainting, dizziness, feeling lightheaded (low blood pressure)
  - hives
- **Eye problems.** Tell your healthcare provider if you have any new or worsening eye problems, including eye pain or changes in vision.

**The most common side effects of ADBRY include:**

- Upper respiratory tract infections
- Eye and eyelid inflammation, including redness, swelling, and itching
- Injection site reactions
- High count of a certain white blood cell (eosinophilia)

These are not all the possible side effects of ADBRY. Call your doctor for medical advice about side effects. You may report side effects to FDA at 1-800-FDA-1088.

**Please see the accompanying full Prescribing Information, Patient Information, and Instructions for Use in the pocket.**



The LEO Pharma logo and Adbry® are registered trademarks and Advocate™ is a trademark of LEO Pharma A/S.  
© 2024 LEO Pharma Inc. All rights reserved. MAT-76184 September 2024

**Adbry®**  
(tralokinumab-ldrm)  
Injection 150 mg • 300 mg



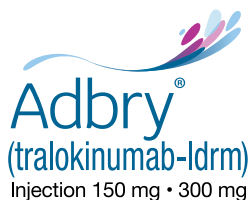

### **Enroll in the Adbry® Advocate™ Program today**

The Adbry® Advocate™ Program may provide you with helpful treatment resources, and, if eligible, savings and support programs.\*

\*Restrictions apply. See full terms, conditions, and eligibility criteria at [www.ADBRY.com/terms-conditions](http://www.ADBRY.com/terms-conditions).



#### **Scan to save number**

Having your Case Manager's number saved in your phone can help you easily identify when they call to discuss important information.

**844-MY-ADBRY (844-692-3279)**

---

**[www.ADBRY.com](http://www.ADBRY.com)**