

Adbry[®]
(tralokinumab-ldrm)
Injection 150 mg • 300 mg



Not actual size.

Training Demonstration Autoinjector Reference Guide

For Training Purposes Only

Welcome!

Your healthcare professional has shown you how to inject Adbry[®], and now you can practice doing it yourself at home.

1. Read your Welcome Kit.
2. Take a look at the enclosed Training Demonstration Autoinjector.*
3. Follow the steps in this guide to practice self-injections at home.

If you still have questions, talk to your doctor, watch a training video at www.Adbry.com/how-to-use-adbry, or call your Case Manager at **844-MY-ADBRY (844-692-3279)**.

*This device lets you practice injections with no needle and no medication. Restrictions apply. See Full Terms, Conditions, and Eligibility Criteria at Adbry.com/terms-conditions.

INDICATION AND IMPORTANT SAFETY INFORMATION

What is ADBRY?

- ADBRY[®] (tralokinumab-ldrm) injection is a prescription medicine used to treat people 12 years of age and older with moderate-to-severe atopic dermatitis (eczema) that is not well controlled with prescription therapies used on the skin (topical), or who cannot use topical therapies. ADBRY can be used with or without topical corticosteroids.
- It is not known if ADBRY is safe and effective in children under 12 years of age.

Do not use ADBRY if you are allergic to tralokinumab or to any of its ingredients.

What should I discuss with my healthcare provider before starting ADBRY?

Tell your healthcare provider about all your medical conditions, including if you:

- have eye problems.
- have a parasitic (helminth) infection.

Please see additional Important Safety Information throughout and accompanying full Prescribing Information, including Patient Information and Instructions for Use.

Training Demonstration Autoinjector

**FOR TRAINING PURPOSES ONLY.
DOES NOT CONTAIN A NEEDLE OR MEDICATION.**

These are the training instructions for the Training Demonstration Autoinjector only. Practice with it, reset it, and repeat the process as many times as you'd like, or until you feel comfortable.

The Training Demonstration Autoinjector and this guide do not replace learning how to self-inject Adbry from your healthcare professional. When administering Adbry with an actual autoinjector, needle, and medication, please refer to the Instructions for Use that come inside the Adbry carton.

Before Use



After Use

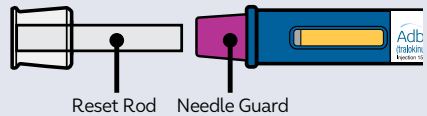

How to Reset

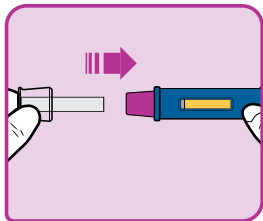

To reset the device, replace the cap. The yellow plunger will disappear and then you are ready to practice with it again.

⚠ Do not attempt to reset the real Adbry® Autoinjector after a real injection. Never recap a real Autoinjector. Used real Adbry Autoinjectors should be placed in a sharps disposal container directly after use.

INDICATION AND IMPORTANT SAFETY INFORMATION (cont'd)

What should I discuss with my healthcare provider before starting ADBRY? (cont'd)

- are scheduled to receive any vaccinations. You should not receive a "live vaccine" if you are treated with ADBRY.
- are pregnant or plan to become pregnant. It is not known whether ADBRY will harm your unborn baby. There is a pregnancy exposure registry for women who use ADBRY during pregnancy. The purpose of this registry is to collect information about the health of you and your baby. You or your healthcare provider can get information and enroll you in this registry by calling 1-877-311-8972 or visiting <https://mothertobaby.org/ongoing-study/adby-tralokinumab/>.

How to Use

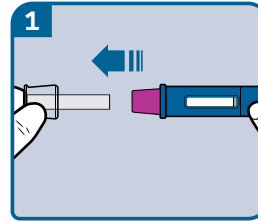

Hold the Training Demonstration Autoinjector with one hand, pull the cap straight off with your other hand, and set cap aside as you will need this to reset the device later.

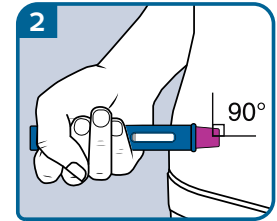

Place the needle guard of the Training Demonstration Autoinjector flat against your skin (90-degree angle) at the injection site.

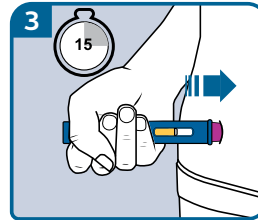

Press the Training Demonstration Autoinjector down firmly and hold it in place. You will hear a "click" to let you know that the injection has started, and the yellow plunger will start to move. Hold the device until the yellow plunger has moved to fill all of the viewing window (this may take up to 15 seconds) and you will hear a second click.

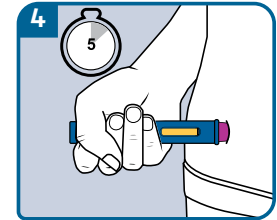

Continue to press the Training Demonstration Autoinjector firmly against your skin for 5 seconds to simulate what it's like when you get your full dose.

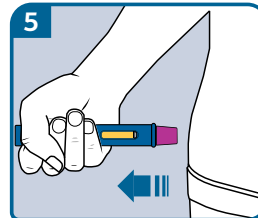

Pull the Training Demonstration Autoinjector straight away from the injection site. The needle guard will slide down and lock into place over the simulated needle.

Devices shown are not actual size.

Please see additional Important Safety Information throughout and accompanying full Prescribing Information, including Patient Information and Instructions for Use.

INDICATION AND IMPORTANT SAFETY INFORMATION (cont'd)

What should I discuss with my healthcare provider before starting ADBRY? (cont'd)

- are breastfeeding or plan to breastfeed. It is not known whether ADBRY passes into your breast milk and if it can harm your baby.

Tell your healthcare provider about all the medicines you take, including prescription and over-the-counter medicines, vitamins, and herbal supplements.

How should I use ADBRY?

- **See the detailed “Instructions for Use” that comes with ADBRY for information on how to prepare and inject ADBRY and how to properly store and throw away (dispose of) used ADBRY prefilled syringes and autoinjectors.**
- Use ADBRY exactly as prescribed by your healthcare provider.
- Your healthcare provider will tell you how much ADBRY to inject and when to inject it.
- ADBRY comes as a single-dose prefilled syringe with needle guard or as an autoinjector.
- ADBRY is given as an injection under the skin (subcutaneous injection).
- If your healthcare provider decides that you or a caregiver can give the injections of ADBRY, you or your caregiver should receive training on the right way to prepare and inject ADBRY. **Do not** try to inject ADBRY until you have been shown the right way by your healthcare provider. In children 12 years of age and older, it is recommended that ADBRY be given by or under supervision of an adult.
- If you miss a dose, inject the missed dose as soon as possible, then continue with your next dose at your regular scheduled time.
- If you inject too much ADBRY than prescribed, call your healthcare provider or call Poison Help line at 1-800-222-1222 or go to the nearest hospital emergency room right away.
- Your healthcare provider may prescribe other medicines to use with ADBRY. Use the other prescribed medicines exactly as your healthcare provider tells you to.

What are the possible side effects of ADBRY?

ADBRY can cause serious side effects, including:

- **Allergic reactions (hypersensitivity), including a severe reaction known as anaphylaxis.** Stop using ADBRY and tell your healthcare provider or get emergency help right away if you get any of the following symptoms:
 - breathing problems
 - swelling of the face, mouth, and tongue
 - itching
 - fainting, dizziness, feeling lightheaded (low blood pressure)
 - skin rash
 - hives
- **Eye problems.** Tell your healthcare provider if you have any new or worsening eye problems, including eye pain or changes in vision.

The most common side effects of ADBRY include:

- Upper respiratory tract infections
- Eye and eyelid inflammation, including redness, swelling, and itching
- Injection site reactions
- High count of a certain white blood cell (eosinophilia)

These are not all the possible side effects of ADBRY. Call your doctor for medical advice about side effects. You may report side effects to FDA at 1-800-FDA-1088.

Please see additional Important Safety Information throughout and accompanying full Prescribing Information, including Patient Information and Instructions for Use.



The LEO Pharma logo and Adbry[®] are registered trademarks of LEO Pharma A/S.
© 2024 LEO Pharma Inc. All rights reserved.
MAT-73748 August 2024

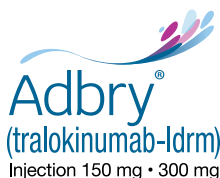

Adbry[®]
(tralokinumab-ldrm)
Injection 150 mg • 300 mg